

ALLDAY
& MILLER

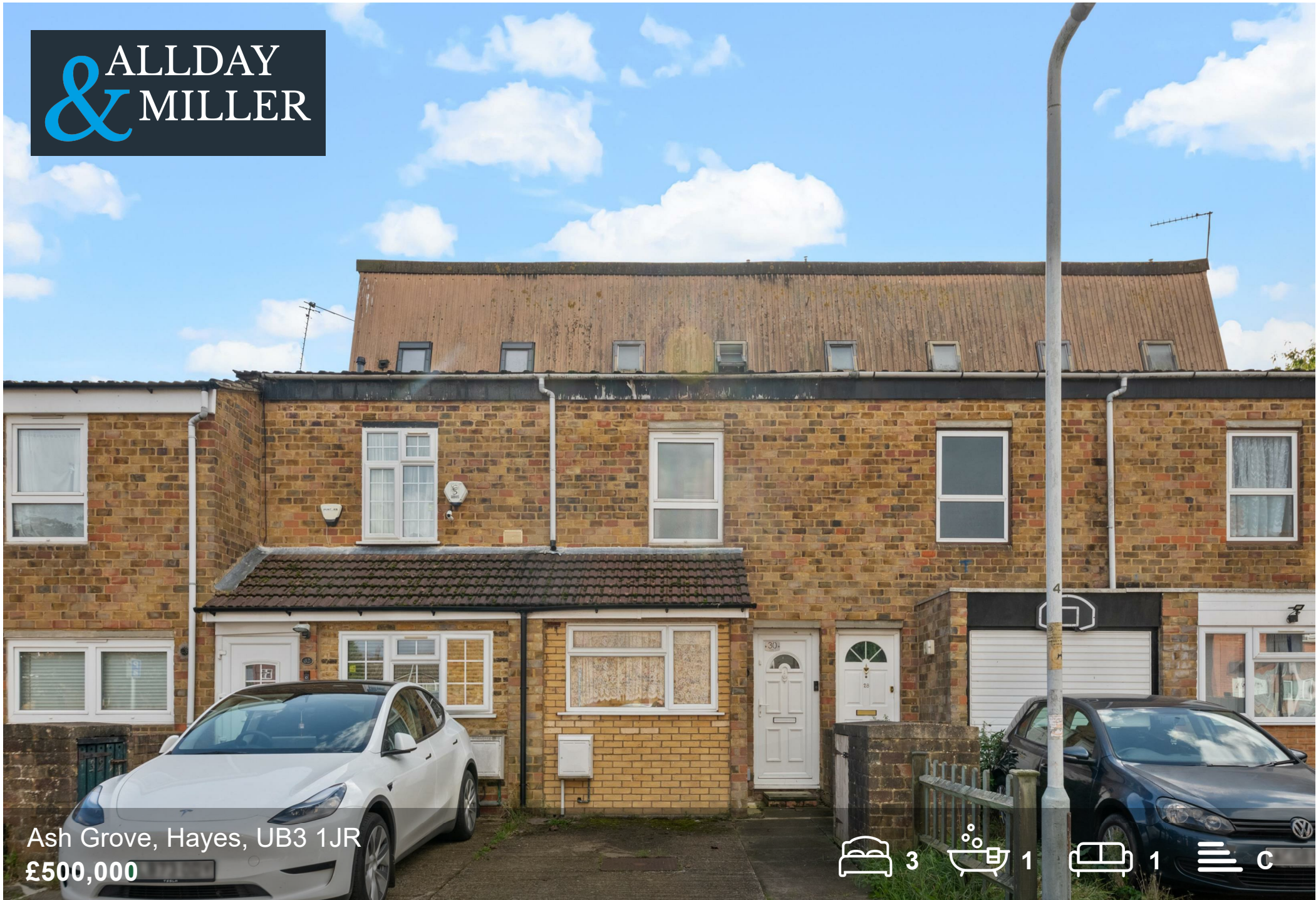

Ash Grove, Hayes, UB3 1JR
£500,000



3



1



1





Ash Grove, Hayes, UB3 1JR

£500,000

- Three / Four Double Bedrooms
- Quiet Location
- Large Reception Room
- Low Maintenance Rear Garden
- Freehold
- Off Street Parking
- Town House
- Great Investment Opportunity

Description

This property brought to the market measuring 1048 Sq Ft comprises of a reception room and a modern fitted kitchen/ dining room which provides access to the rear garden.

The first floor enjoys two double bedrooms and a WC.

Rising to the second floor provides a double bedroom and a bathroom.

A front driveway space for off street parking. To the rear a private and secluded garden with a store cupboard, ideal for extra storage space.

Situation

Ash Grove situated in the heart of Hayes being close to a number of local amenities including Hayes and Harlington station with the Elizabeth line. Stockley Business Park, Heathrow Airport & the M4 Motorway are also within an easy reach. Uxbridge Town centre being just a short drive away with its array of restaurants, coffee shops, bars and local shops. There are also a number of highly regarded schools in the local area including Hayes Park primary School and Grange Park Primary School.



Floor Plans

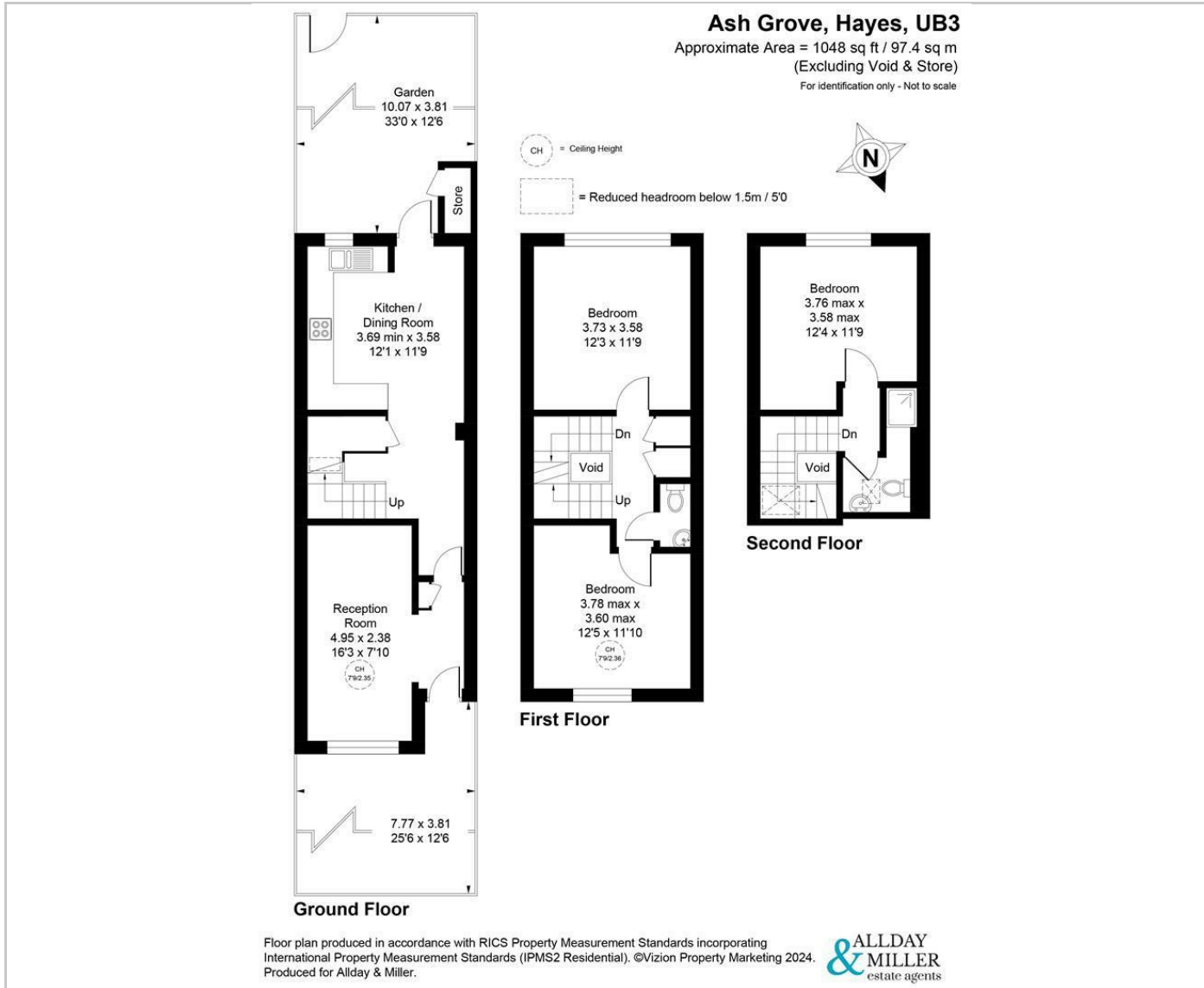

Area Map

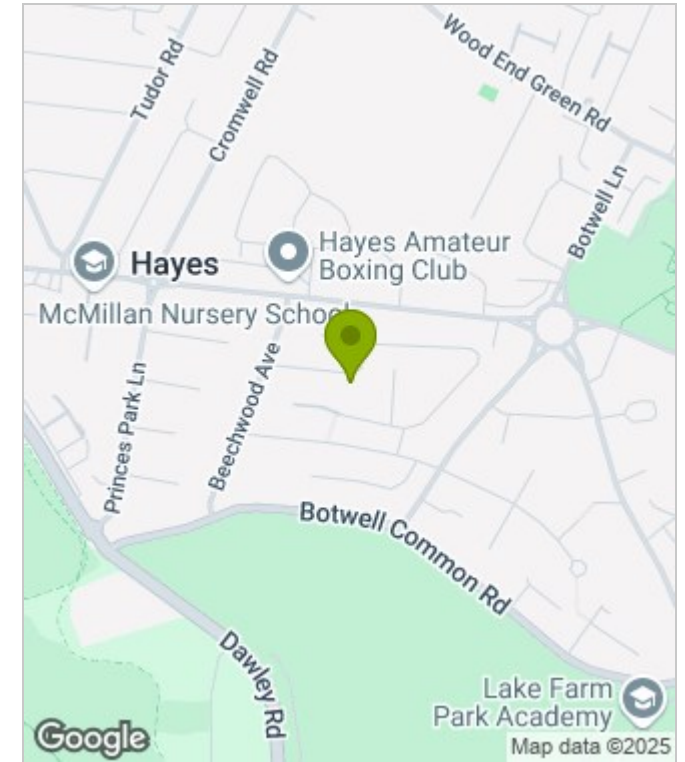

Energy Performance Graph

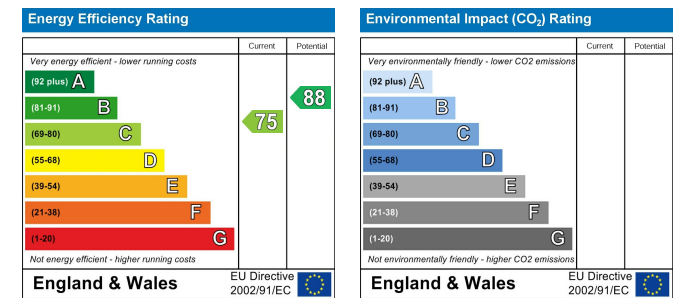

These particulars, whilst believed to be accurate are set out as a general outline only for guidance and do not constitute any part of an offer or contract. Intending purchasers should not rely on them as statements of representation of fact, but must satisfy themselves by inspection or otherwise as to their accuracy. No person in this firm's employment has the authority to make or give any representation or warranty in respect of the property.